

477 Bethnal Green Road, London, E2 9QH



£65,000 Per annum

477 Bethnal Green Road, London, E2 9QH

477 Bethnal Green Road (E2 9QH)

McDowalls are pleased to offer this Class E usage (Previously A3/A4/A5) establishment for rental.

Rent - £65,000 pa

Area - 132 SqM

Area - 1420 SqFt

RV - £37,250.00

EPC - C

*** VIEWING VIA APPOINTMENT ONLY ***

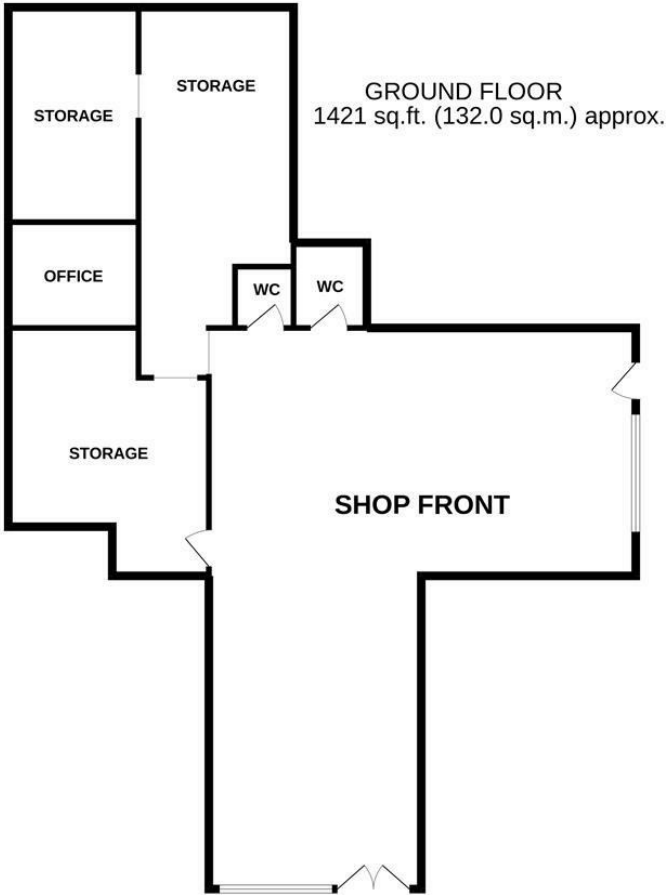



477 BETHNAL GREEN ROAD E2 9QH

TOTAL FLOOR AREA: 1421 sq.ft. (132.0 sq.m.) approx.

Whilst every attempt has been made to ensure the accuracy of the floorplan contained here, measurements of doors, windows, rooms and any other items are approximate and no responsibility is taken for any error, omission or misstatement. This plan is for illustrative purposes only and should be used as such by any prospective purchaser. The services, systems and appliances shown have not been tested and no guarantee as to their operability or efficiency can be given.
Made with Metreplex 12/2022

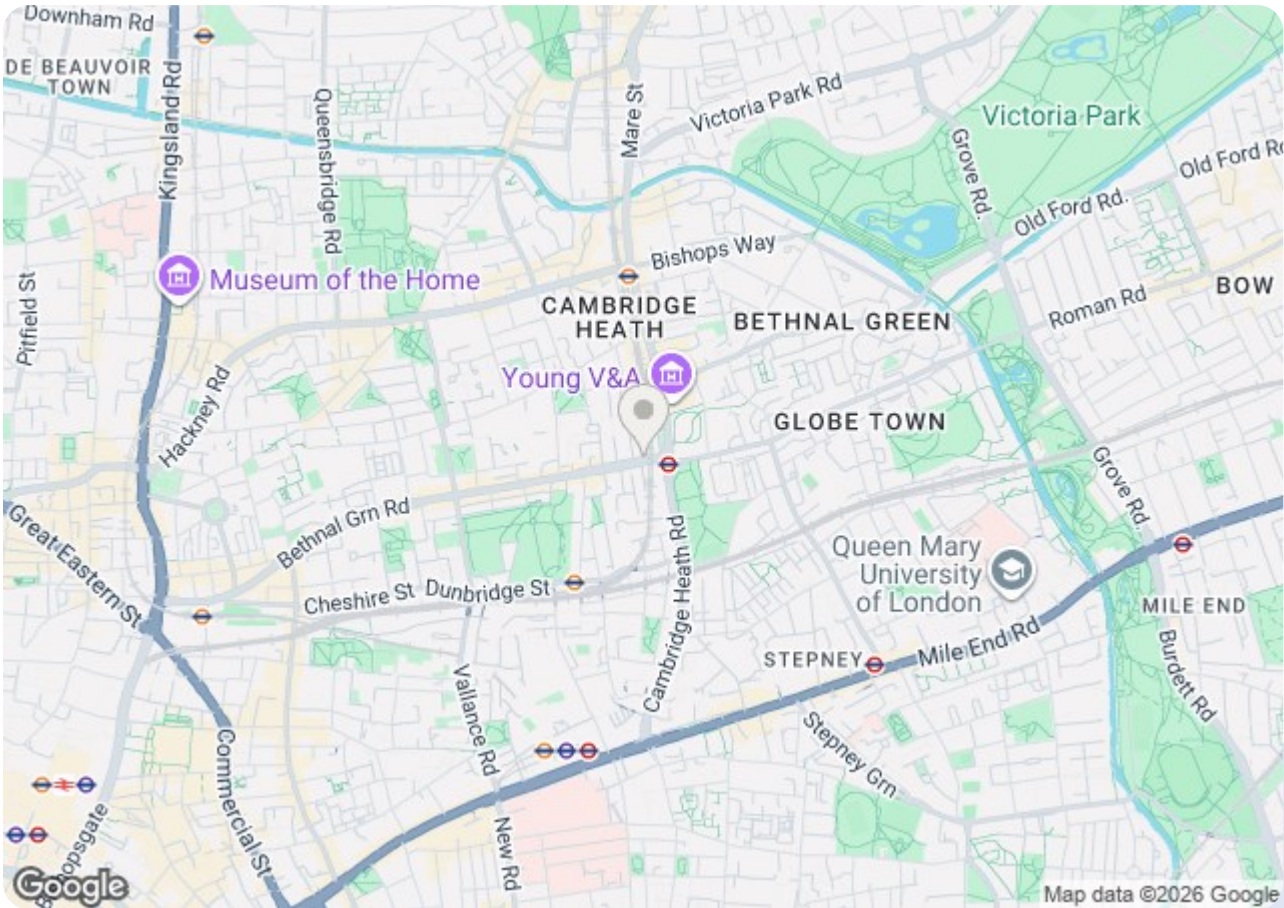
54/56 Barking Road
East Ham, London E6 3BP
Telephone: (020) 8472 4422
Property Management: (020) 8471 4224
Fax: (020) 8471 5052
E-mail: eastham@mcdowalls.com
Website: www.mcdowalls.com



Energy Efficiency Rating		
	Current	Potential
Very energy efficient - lower running costs		
(92 plus) A		
(81-91) B		
(69-80) C		
(55-68) D		
(39-54) E		
(21-38) F		
(1-20) G		
Not energy efficient - higher running costs		
England & Wales	EU Directive 2002/91/EC	

Environmental Impact (CO ₂) Rating		
	Current	Potential
Very environmentally friendly - lower CO ₂ emissions		
(92 plus) A		
(81-91) B		
(69-80) C		
(55-68) D		
(39-54) E		
(21-38) F		
(1-20) G		
Not environmentally friendly - higher CO ₂ emissions		
England & Wales	EU Directive 2002/91/EC	